



864 Fireback Installation Instructions

(Enamel Black 96100827 Stainless Steel 96100829)

Compatibility

- 864 TRV GS
- 864 HO (**NOTE:** these firebacks are not compatible with Diamond-Fyre Burner)

Packing List

- Rear Fireback
- (2) Side Firebacks
- Floor Fireback

STAINLESS STEEL WARNINGS

HANDLING THE FIREBACKS: The stainless steel firebacks are shipped in vinyl to prevent marring the surface of the stainless steel. Remove the vinyl prior to installation. **Wear clean gloves when installing the firebacks** to prevent fingerprints on the surface (or use a rag or paper towel to handle the firebacks).

COLORATION AND CLEANING: These stainless steel firebacks will obtain a slight "patina" (brown tint) after use. Do not clean the firebacks. This patina becomes consistent. Any cleaning may lead to unequal coloring. If soot forms on the fireback, we recommend brushing it off with a soft cloth or brush.

CLEANING ENAMEL FIREBACKS

We recommend cleaning the enamel surface with glass cleaner and a soft cloth.

Installation

WARNING Turn off gas to the appliance and make sure it has fully cooled prior to conducting service.

- 1 Remove the glass frame and logs (see the installation manual for details).
- 2 Follow the directions below to prepare the firebox.

864 TRV GS Only

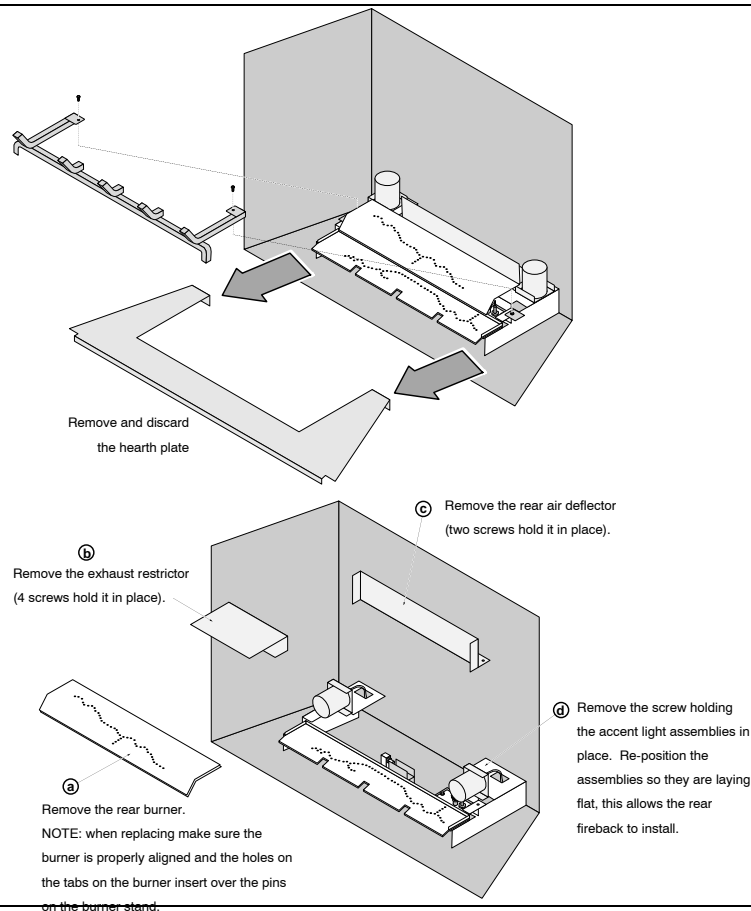

864 HO GS Only

Remove the grate from the burner prior to installation.



864 Fireback Installation Instructions

(Enamel Black 96100827 Stainless Steel 96100829)

3 Install the firebacks following the directions below

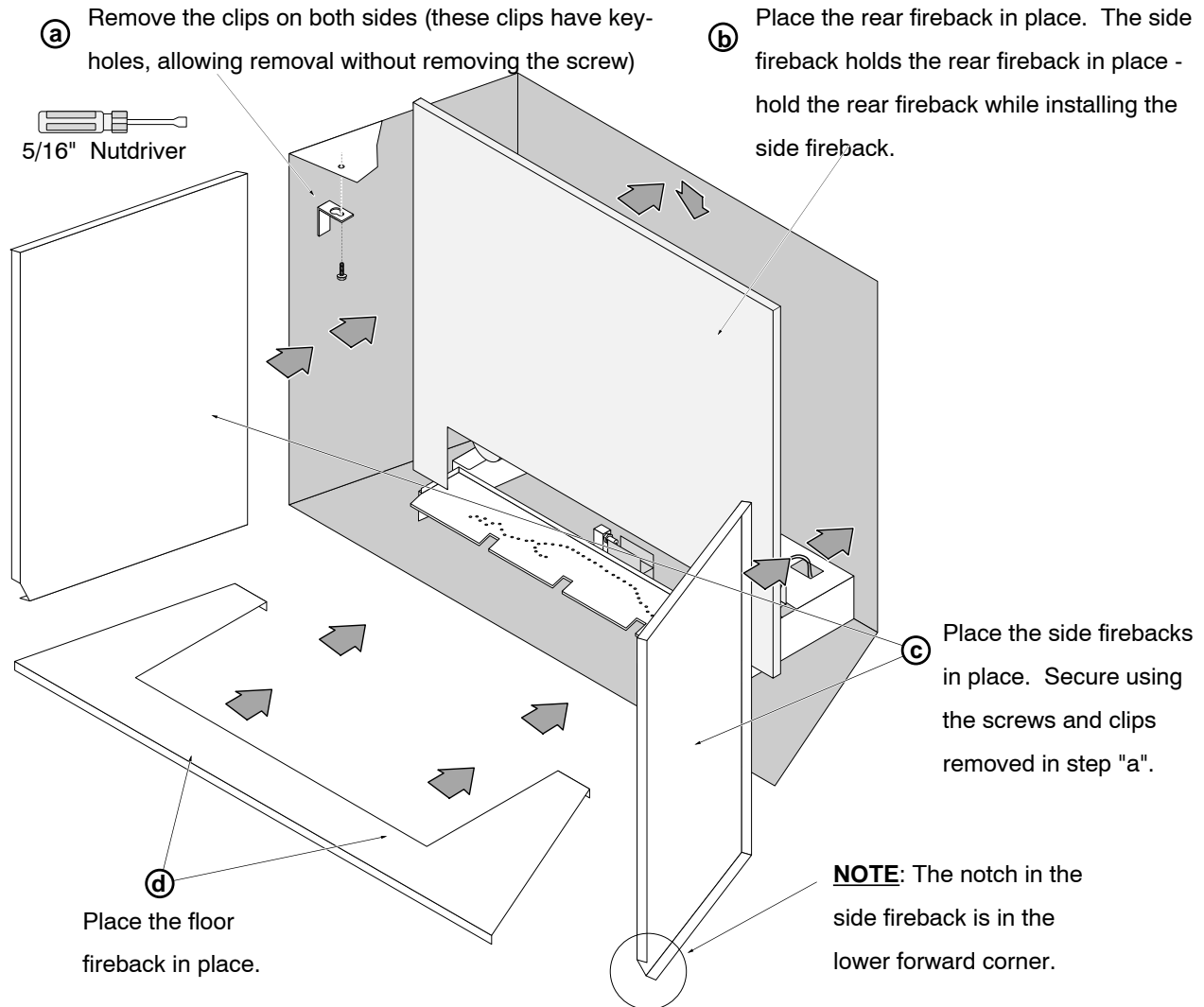

4 Restore the fireplace to the correct configuration.