



hunterstoves
GROUP

FLUE COLLAR ASSEMBLY

Fit 4 - M6 x 16 Countersink Screws and tighten.

Place Flue Collar up side down on bench.

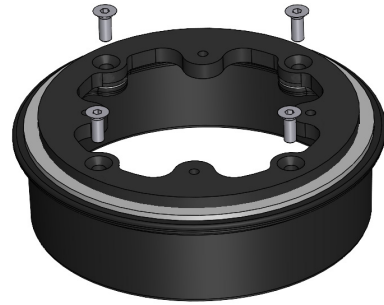

Place Flue Collar Gasket on top.

Screw in 4 - M6 Studs.
Align the end of the Stud to the underside of the Collar Flange



Place Adaptor Plate on top.

Turn over and fit the
M8 x 10 Button Head Screw



SECTION VIEW FOR CLARITY

Place Flue Collar assembly onto appliance and fit M6 Washers & Nuts
It may be necessary to remove the Vermiculite and Steel Baffles to improve access

